



Seal Type ZR200/D - Double Semi Cartridge With Back Plate

PRODUCT DESCRIPTION

Designed to handle solids up to 60% by weight. Specially designed stuffing box in this particular seal type ZR200/D which gives better seal life and performance. Hydraulically balanced faces for excellent seal reliability. Springs are located outside the process. Flushing helps to lubricate or cool the seal faces from atmospheric side of mechanical seal. They are cost effective for basic application such as Centrifugal Pumps and other Equipment with Rotating Shaft, Handling Crystallizing Slurry, Suspended Solid Slurry, Saturated Chemical Slurry, General Chemical Slurry

DESIGN FEATURES

Slurry seal. Standardized modular design. Single Acting Mechanical Seals. Inside Mounted

MATERIALS

Seal Ring Faces : SiC, Carbon and TC
Seat Faces : SiC and TC
Elastomer : Viton, TTV, FEP and FFKM
MOC : SS 316 – CHANGE OF MOC ON REQUEST

OPERATING CAPABILITIES

Shaft Dia. : 20mm to 80mm
Pressure : Full Vacuum to 8 bar
Temperature: -30°C to 260°C (Depending upon Elastomer)
Speed : 3000 r.p.m.

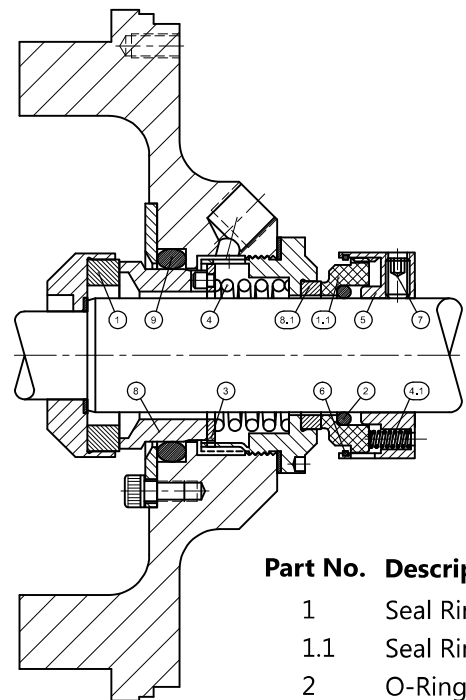

Part No.	Description
1	Seal Ring
1.1	Seal Ring
2	O-Ring
3	Thrust Ring
4	Spring
4.1	Spring
5	Spring Holder
6	Snap Ring
7	Set Screw
8	Seat
8.1	Seat
9	O-Ring